

SLX Crankset

**FC-M7100-1 FC-M7100-2**  
**BB-MT800 SM-CRM75**

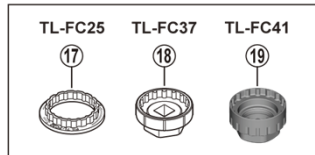
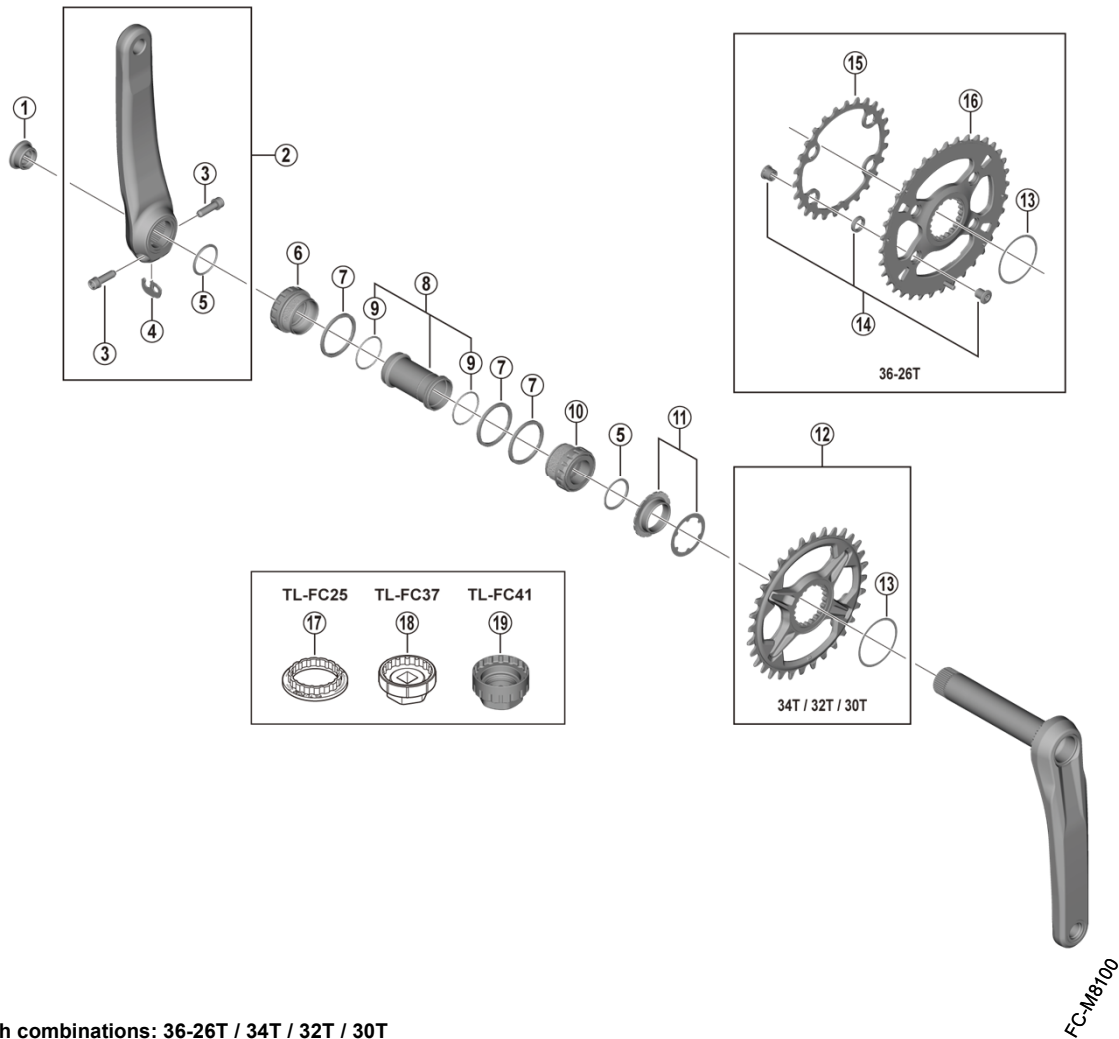

• Chaining teeth combinations: 36-26T / 34T / 32T / 30T

ITEM NO.	SHIMANO CODE NO.	DESCRIPTION	INTERCHANGE-ABILITY
1	Y0J620000	Crank Arm Fixing Bolt	A
2	Y0J998010	Left Hand Crank Arm Unit 165 mm	
	Y0J998020	Left Hand Crank Arm Unit 170 mm	
	Y0J998030	Left Hand Crank Arm Unit 175 mm	
3	Y1GS21000	Clamp Bolt with Washer (M6 x 21)	A
4	Y0J698050	Plate	A
5	Y1F316000	Ring	A
6	Y1V698010	Left Hand Adapter (B.C.1.37" x 24T) English Thread (BB-MT800)	A
7	Y1P804000	Spacer (2.5 mm)	A
8	Y1E598210	Inner Cover & O-Ring	A
9	Y1TF21000	O-Ring	A
10	Y1V698020	Right Hand Adapter (B.C.1.37" x 24T) English Thread (BB-MT800)	A
11	Y0J698060	Lock Ring & Washer	A
12	ISMCRM75A0	Chaining 30T w/Spacer (SM-CRM75)	
	ISMCRM75A2	Chaining 32T w/Spacer (SM-CRM75)	
	ISMCRM75A4	Chaining 34T w/Spacer (SM-CRM75)	
13	Y0JC61000	Spacer	A
14	Y0JB98020	Gear Fixing Bolt Unit (4 sets)	B
15	Y0J826000	Chaining 26T-BJ for 36-26T	A
16	Y0JB98010	Chaining 36T-BJ for 36-26T	B
17	Y13009260	TL-FC25 Adapter Installation Tool	
18	Y13009270	TL-FC37 Adapter Installation Tool	
19	Y13098720	TL-FC41 Front Chaining Direct Mount Tool	

A: Same parts.

B: Parts are usable, but differ in materials, appearance, finish, size, etc.

Absence of mark indicates non-interchangeability.

Specifications are subject to change without notice.

Aug.-2019-4599

© Shimano Inc. I

**SHIMANO**