

DEORE Shifting Lever (I-spec EV) SL-M6100-I (1x12-speed)

For Right Hand

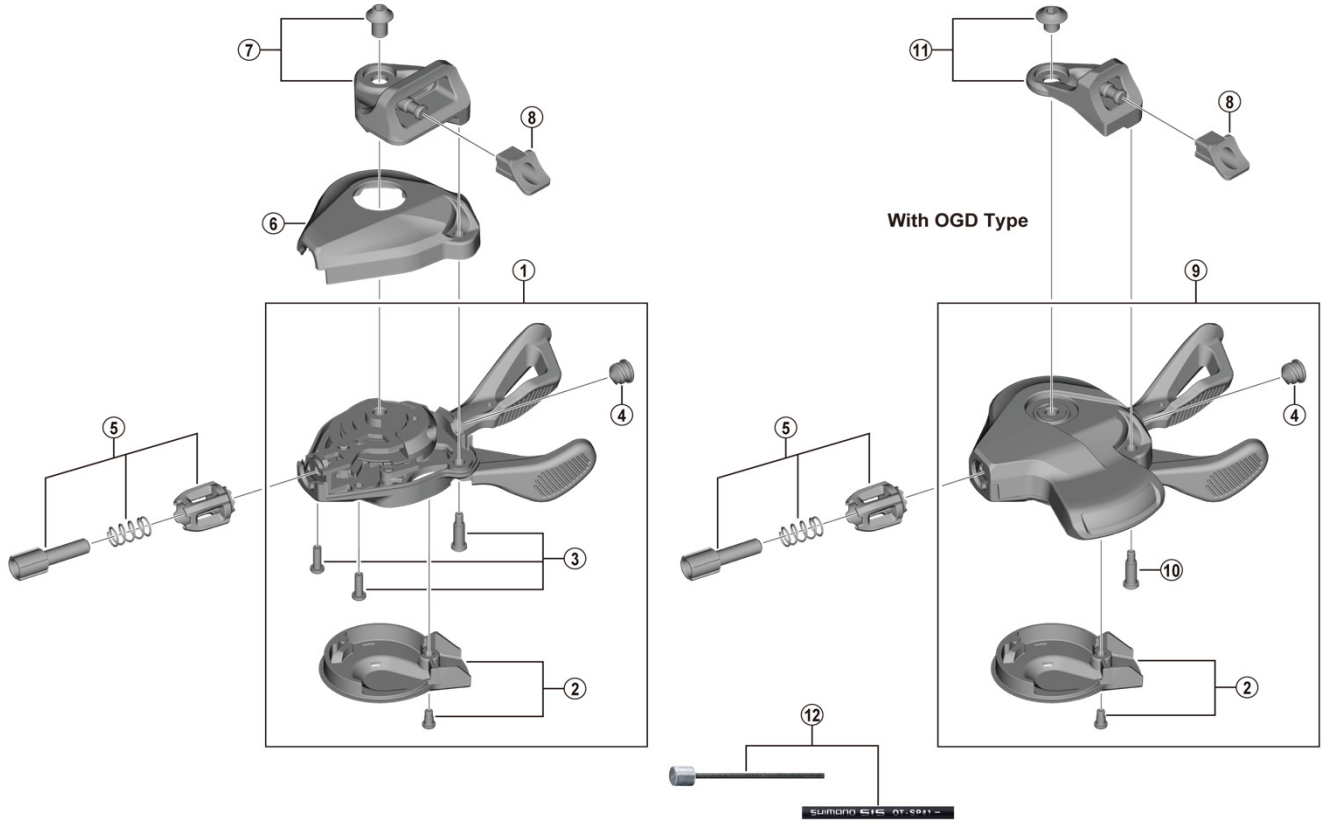

SL-M7100-I

ITEM NO.	SHIMANO CODE NO.	DESCRIPTION	INTERCHANGEABILITY	
1	Y0L098010	R.H. Shifting Lever Unit	B	
2	Y0L098020	R.H. Main Lever Cover & Fixing Screw	B	
3	Y0L098030	R.H. Base Cover Fixing Screw Unit	B	
4	Y6CD33000	Inner Hole Cap	A	
5	Y03K98030	R.H. Cable Adjustment Barrel Unit	A	
6	Y0L001000	R.H. Base Cover	B	
7	Y0GV98050	R.H. Bracket Unit	A	
8	Y0GT10000	Integration Nut	A	
9	Y0L098040	R.H. Shifting Lever Unit for With OGD Type		
10	Y0L010000	M2.5 Screw	B	
11	Y0L098060	R.H. Bracket Unit for With OGD Type		
12	Y60198090	OT-SP41 OPTISLICK shift cable sets (Black) • Sealed outer caps, plastic (9 pcs.) • Sealed outer cap nose (1 pc.) • Rubber shield (1 pc.) • Inner end caps (2 pcs.)	A	
	Y60198091	OT-SP41 OPTISLICK shift cable sets (White) • Sealed outer caps, plastic (9 pcs.) • Sealed outer cap nose (1 pc.) • Rubber shield (1 pc.) • Inner end caps (2 pcs.)	A	

A: Same parts.

B: Parts are usable, but differ in materials, appearance, finish, size, etc.

Absence of mark indicates non-interchangeability.

Specifications are subject to change without notice.

Jun.-2020-4680

© Shimano Inc. I

SHIMANO