

DEORE Shifting Lever (I-spec EV) SL-M4100-I (2/1x10-speed)

For Right Hand

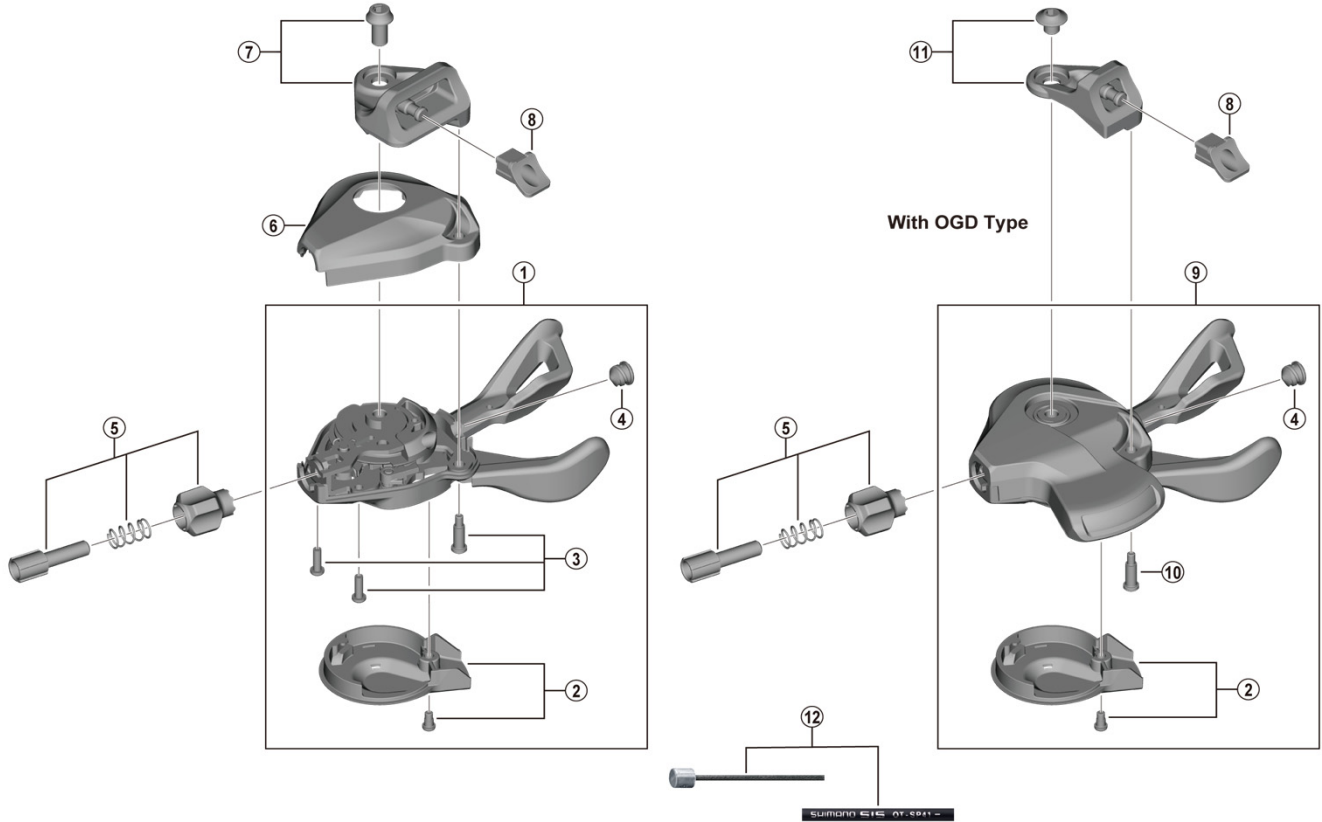

ITEM NO.	SHIMANO CODE NO.	DESCRIPTION
1	Y0LD98010	R.H. Shifting Lever Unit
2	Y0L098020	R.H. Main Lever Cover & Fixing Screw
3	Y0L098030	R.H. Base Cover Fixing Screw Unit
4	Y6CD33000	Inner Hole Cap
5	Y6TA98020	R.H. Cable Adjustment Barrel Unit
6	Y0LD01000	R.H. Base Cover
7	Y0L898040	R.H. Bracket Unit
8	Y0GT10000	Integration Nut
9	Y0LD98020	R.H. Shifting Lever Unit for With OGD Type
10	Y0L010000	M2.5 Screw
11	Y0L898050	R.H. Bracket Unit for With OGD Type
12	Y60198090	OT-SP41 OPTISLICK shift cable sets (Black) • Sealed outer caps, plastic (9 pcs.) • Sealed outer cap nose (1 pc.) • Rubber shield (1 pc.) • Inner end caps (2 pcs.)
	Y60198091	OT-SP41 OPTISLICK shift cable sets (White) • Sealed outer caps, plastic (9 pcs.) • Sealed outer cap nose (1 pc.) • Rubber shield (1 pc.) • Inner end caps (2 pcs.)

May-2020-4678

© Shimano Inc. I

Specifications are subject to change without notice.

SHIMANO